

- 1 FLIP LID IN OPEN POSITION
- 2 GFI OUTLET AND SWITCH
- 3 CALSENSE STAINLESS STEEL FACTORY ASSEMBLED ENCLOSURE
- 4 #6 BARE COPPER GROUND WIRE
- 5 (38" x 24" x 8") CONCRETE BASE
- 6 FINISH GRADE 2" BELOW CONCRETE BASE (LAWN OR OTHER)
- 7 (5/8" x 8') COPPER GROUND ROD. INSTALL GROUND ROD 8' FROM ASSEMBLY (SEE GROUNDING INSTRUCTIONS FOR MORE DETAILS)
- 8 SCH 40 PVC ELECTRICAL SWEEP FOR FIELD WIRES (2 TYP)
- 9 SCH 40 PVC ELECTRICAL SWEEP FOR SOLAR PANEL POWER
- 10 MOUNTING J-BOLT (4 TYP)
- 11 LOUVERED VENT (TYP)
- 12 BATTERY COMPARTMENT DUAL LITHIUM BATTERIES
- 13 POWER INVERTER
- 14 PISTON

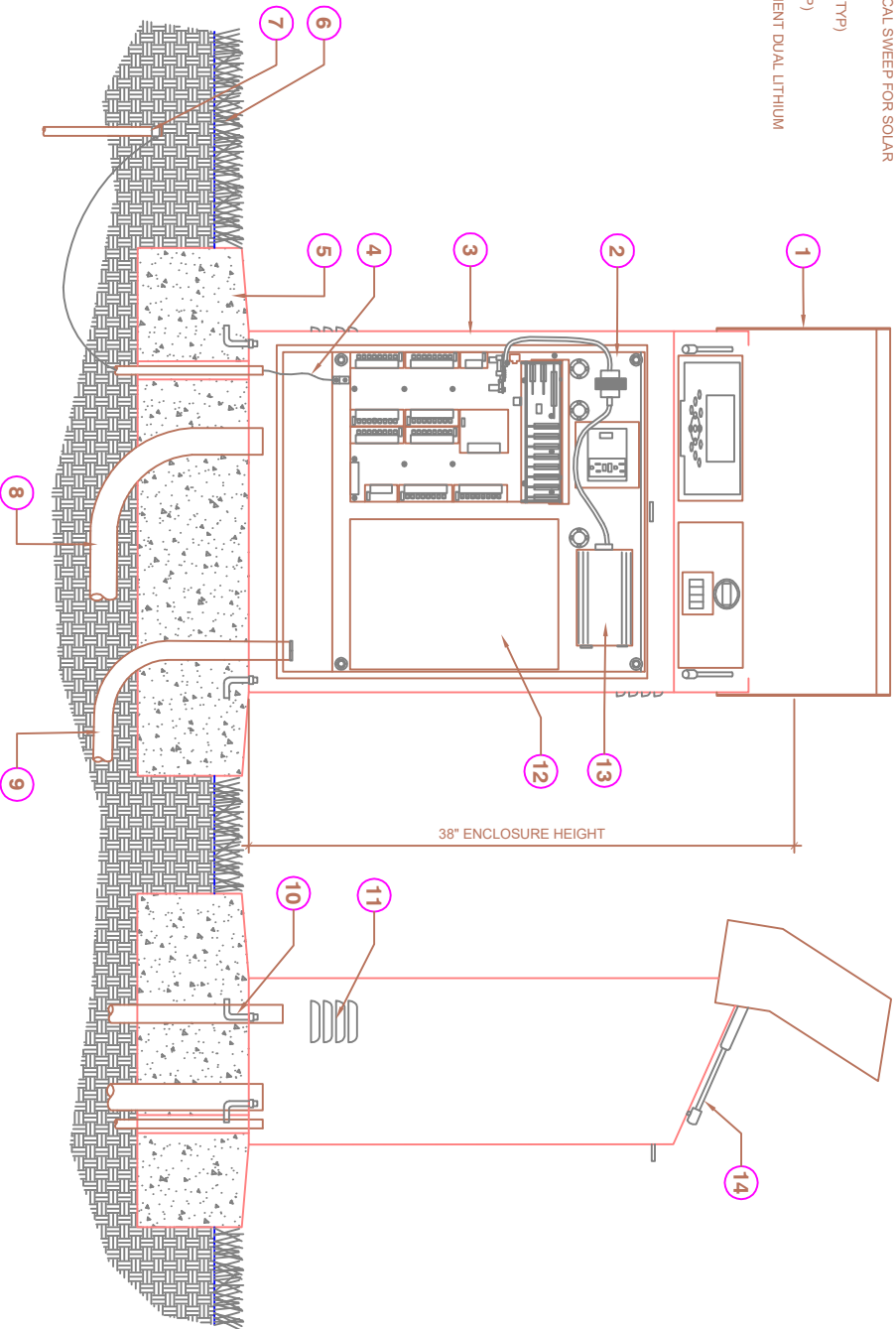

NOTES:  
 ALLOW MINIMUM OF 7 INCHES BEHIND ENCLOSURE FOR FULLY OPENED LID